

# INSTALLATION INSTRUCTIONS



No. 940190



## CUSTOM MOLDED REAR MUD GUARDS FOR SILVERADO

### Tools Needed

- Drill with 1/8" bit
- Center punch
- Phillips head screwdriver

### Included in Box

- Rear Mud Guards (for driver & passenger side)
- Film to protect vehicle
- #10 SEM Screws (8x)

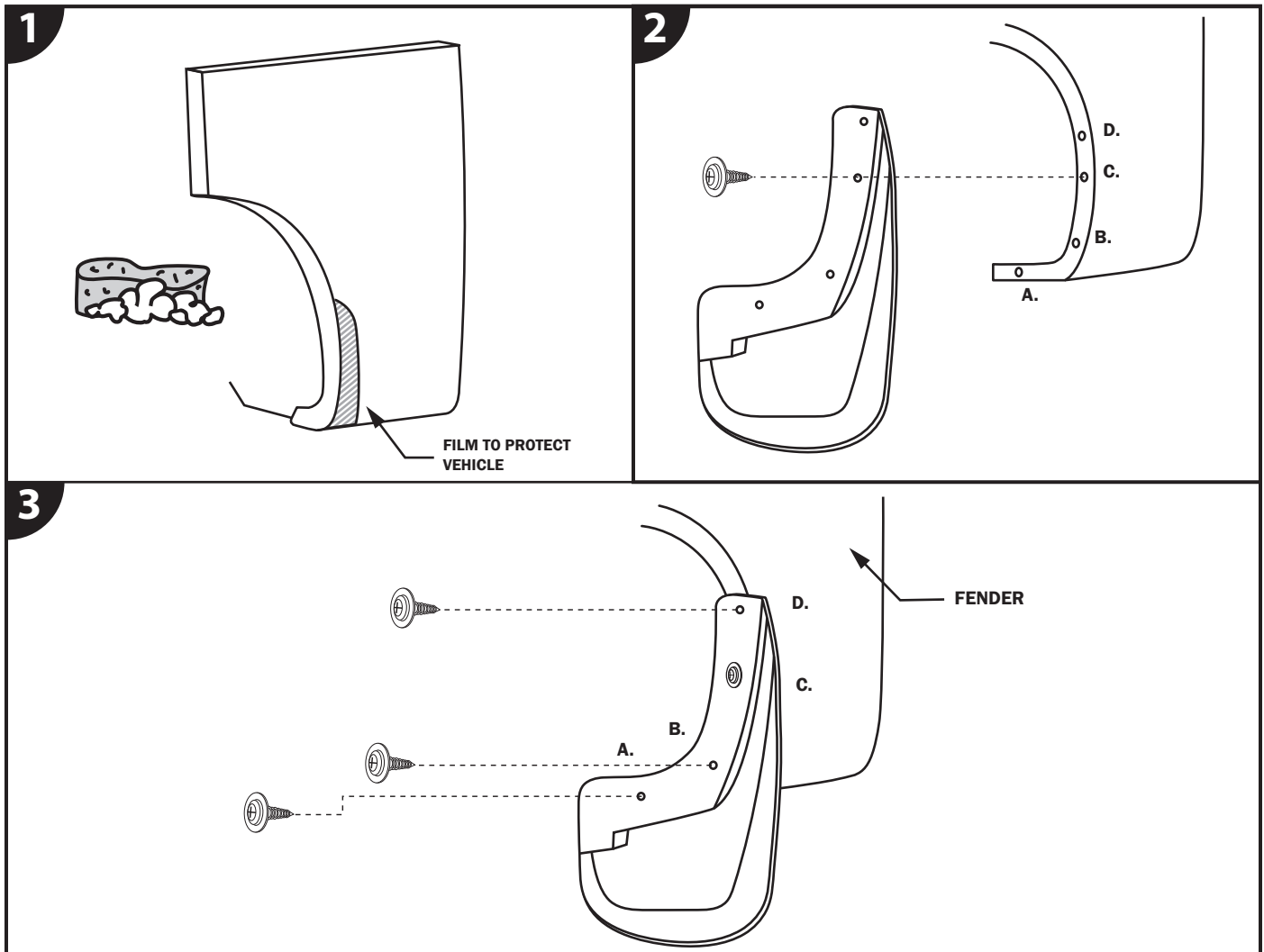

\*Repeat Steps 1-3 for Driver & Passenger Side\*

### STEP 1. Apply film to protect vehicle.

- Using a clean cloth or wet alcohol pad, clean the area on the fender where the film (to protect vehicle) will be placed.
- Use soapy water to wet film, fender, and fingers for a wet film installation. Apply film in location shown in diagram, with adhesive side of film towards the vehicle. Apply pressure and smooth out film with a squeegee or sponge and allow to dry.

### STEP 2. Attach mud guards to fender.

- Position the mud guard on the fender, and center punch and then drill a 1/8" hole at location C.
- Using a #10 SEM screw, attach mud guard to fender at location C. Check alignment before moving on to the next step.

### STEP 3. Install mud guards.

- Use the mud guard as a template to center punch and then drill 1/8" holes at locations A, B, and D.
- Screw in #10 SEM screws at locations A, B, and D.

